

**CNEA WELCOMES YOU TO A FOUR SHOW WEEKEND / ONE LOCATION  
2 INDEPENDENT NORWEIGAN ELKHOUND SPECIALTIES / 2 ALL-BREED SHOWS**

Specialty #1 A.M. / Entry Limited to 100 dogs    Specialty #2 P.M. / Entry Limited to 100 dogs  
ENTRIES for both Specialties CLOSE: 5:00 P.M. – WEDNESDAY – MARCH 28, 2012  
**OR** when numerical limit has been reached, if reached prior to this date & time

After which time entries cannot be accepted, cancelled, altered, or submitted except as provided for in Chapter 11, Section 6, *AKC Rules Applying to Dog Shows*



**CNEA PREMIUM LIST**

**FRIDAY, APRIL 13, 2012**

Event #: 2012-053901

**39<sup>th</sup> SPECIALTY SHOW**

Event #: 2012-053903

**40<sup>th</sup> SPECIALTY SHOW**

A.K.C. Licensed -- Unbenched

**SPECIALTY #1 / A.M. .... Specialty (Regular & Non-Regular Classes)  
Puppy Sweepstakes / Veteran Sweepstakes / Junior Showmanship**

**SPECIALTY #2 / P.M. .... Specialty (Regular & Non-Regular Classes ONLY)**

**LOCATION ..... Adams County Fairgrounds --- Exhibition Building  
9755 Henderson Road -- Brighton Colorado 80601**

There will be **NO ACCESS** to Adams County Fairgrounds Buildings **prior to 7:00 a.m., April 13, 2012**

**SHOW HOURS: 7:00 a.m. to 8:00 p.m. .... These shows will be held INDOORS**

**SHOW SECRETARY:**  
**[www.JDCurtis-ShowSecretary.com](http://www.JDCurtis-ShowSecretary.com)**

JAN D. CURTIS  
2837 W 49<sup>th</sup> Street  
Evans CO 80620-9516

Phone / Fax: (970) 339 3272  
E-mail: [JDC\\_ShowSecretary@msn.com](mailto:JDC_ShowSecretary@msn.com)

**FOR EMERGENCY USE:**

Cell Phone / **Show Sec. (970) 396 6701**  
and First Aid Kit will be available at the  
Show Secretary's table

Police & Fire Department Personnel  
will be **ON-CALL** during show hours



- **TERRY-ALL K.C. OFFERS RESERVED GROOMING IN THE INDOOR ARENA ..... SEE PAGE 19**
- **ELKHOUND SPECIALTY EXHIBITORS WILL BE ALLOWED TO HAVE CRATES AND GROOMING TABLES IN THE EXHIBIT HALL ALL DAY FRIDAY, APRIL 13, 2012 ONLY !**
- **NO CHALK, SCISSORING, DRYERS OR HEAVY-DUTY GROOMING WILL BE ALLOWED.**
- **NO TABLES IN THE EXHIBIT HALL ON SATURDAY OR SUNDAY. CRATES WILL BE ALLOWED IN A DESIGNATED AREA ALONG THE BUILDING WALLS AND IN THE CRATING AREA NEAR THE CLUB / SUPERINTENDENT TABLES.**
- **NO DOGS OR EQUIPMENT MAY BE LEFT IN THE EXHIBIT BUILDING OVERNIGHT.**
- **PLEASE PICK UP HAIR AND TRASH AFTER THE NORWEGIAN ELKHOUND JUDGING EACH DAY.**
- **SEE PAGE 14 .... FOR ADDITIONAL TERRY-ALL KENNEL CLUB ATTENTION EXHIBITORS INFORMATION.**

**ENTRIES FOR BOTH CNEA SPECIALTIES CLOSE: 5:00 P.M. -- WED -- MARCH 28, 2012**  
**OR when the numerical limit has been reached, if reached prior to this date & time**

After which time entries cannot be accepted, cancelled, altered or substituted except as provided for in Chapter 11, Section 6, AKC Rules Applying to Dog Shows

**ENTRY FEES: SEPARATE ENTRY FEE IS REQUIRED FOR EACH DOG IN EACH SHOW ENTERED**  
**Entry Fees include ALL required AKC Recording & Event Service Fees**

**SPECIALTY # 1: A.M. JUDGING** **ENTRY LIMITED TO 100 DOGS**

**\$28.00** for FIRST ENTRY of each dog in Specialty # 1  
**\$22.00** for Additional entry of the same dog in Specialty # 1  
**\$22.00** for Regular Puppy Classes ( 6-9 months & 9-12 months )  
**\$22.00** for Veteran Classes  
**\$22.00** for Brace (as a unit) **Both dogs in a Brace must be entered in another class at this show**  
**\$22.00** for **Puppy Sweepstakes / as an Additional Class**  
**\$22.00** for **Veteran Sweepstakes / need not be entered in any other class**  
**\$22.00** for Junior Showmanship ONLY  
**FREE** as an Additional Class if dog is entered in another class at this show

**SPECIALTY # 2: P.M. JUDGING** **ENTRY LIMITED TO 100 DOGS**

**\$28.00** for FIRST ENTRY of each dog in Specialty # 2  
**\$22.00** for Additional entry of the same dog in Specialty # 2  
**\$22.00** for Regular Puppy Classes ( 6-9 months & 9-12 months )  
**\$22.00** for Veteran Classes  
**\$22.00** for Brace (as a unit) **Both dogs in a Brace must be entered in another class at this show**

**Make all checks payable to: (CNEA) COLUMBINE NORWEGIAN ELKHOUND ASSOCIATION**  
**MAIL TO: Jan D Curtis, Show Secretary -- 2837 W 49<sup>th</sup> Street – Evans CO 80620-9516**  
**PLEASE ! WAIVE ALL SIGNATURE REQUIREMENTS FOR ALL FORMS OF DELIVERY**

**GENERAL ENTRY INFORMATION FOR CURTIS SPECIALTY SHOWS:**

The preferred & still overall best method of specialty entry, is to **MAIL YOUR ENTRIES EARLY** through the US Postal Service

**Please Note: Early entries are deeply appreciated by all Show Secretaries & Superintendents**

Whatever method of entry you use -- Please, **PROOF** your entries carefully, be sure all information is complete & accurate. **PLAN AHEAD ! ALLOW SUFFICIENT TIME FOR PROBLEM SOLVING & ENTRY DELIVERY !**

Entries may be submitted by phone & charged to your credit card thru one of the **ENTRY SERVICES ESTABLISHED FOR THAT PURPOSE**. Entry Services charge an additional fee for using their services

Suggested Entry Services:

Best in Show .....	Arizona .....	Entry Line: 1-800-247-7005
Entries on Time .....	Ohio .....	Entry Line: 1-800-992-8955
ShowTime .....	New Jersey .....	Entry Line: 1-800-798-5531

On-Line Entries may be submitted through:  
 InfoDog ..... North Carolina ..... <http://www.infodog.com/entry>  
 InfoDog charges an additional fee for using their service & entries submitted for shows handled by Show Secretaries will only be taken until 12:00 noon Eastern time two days before the published closing date & time

**ON-LINE CNEA SPECIALTY ENTRIES & CATALOG ORDERS MAY BE SUBMITTED DIRECTLY THRU THE SHOW SECRETARY'S WEBSITE** ..... <http://www.JDCurtis-ShowSecretary.com>  
**On-Line Entry Payment is through the Show Secretary Pay-Pal Account**

**ADD \$5.00 PROCESSING FEE FOR EACH DOG / ENTRY FORM SUBMITTED**

ON-LINE ENTRIES MUST ARRIVE IN THE SHOW SECRETARY'S E-MAIL IN-BOX & PAYMENT MUST BE CONFIRMED BY PAY-PAL PRIOR TO THE DESIGNATED CLOSING DATE & TIME ..... **NO EXCEPTIONS !**

**THE SHOW SECRETARY MAY NOT BE HELD RESPONSIBLE OR LIABLE FOR THE DELAY OR FAILURE OF ON-LINE ENTRIES TO ARRIVE DUE TO INTERRUPTED INTERNET SERVICES**

IF YOU HAVE QUESTIONS ABOUT ANY ENTRY PROCESS, PLEASE CONTACT THE SHOW SECRETARY [JDC\\_SHOWSECRETARY@MSN.COM](mailto:JDC_SHOWSECRETARY@MSN.COM) BEFORE YOU SUBMIT THE ENTRIES !

**ENTRY FEE WILL NOT BE REFUNDED:**

- In the event that a dog is absent, disqualified, excused by veterinarian or judge or barred from competition by action of the show committee
- For duplicate entries
- If the show cannot open or be completed by reason of riots, civil disturbances, fire, an Act of God, public emergency, act of a public enemy, strikes or any other cause beyond the control of the club or show secretary

Canadian Exhibitors must submit entries guaranteed in US Funds

**No entry shall be made and no entry shall be accepted which specifies any condition as to its acceptance. Entries will not be accepted without fees or signatures. Entries not on OFFICIAL AKC ENTRY FORMS (or photocopies or electronic copies of same which do not include the Agreement and Rules on the reverse side) are not acceptable.**

Returned checks do not constitute a valid entry fee. The Show Secretary will add a collection fee to the amount of each returned check. Subsequent returned checks from the same exhibitors may result in their being put on a cash only basis.

Changes, additions or corrections to entry forms must be received in writing, by fax, or e-mail [JDC\\_ShowSecretary@msn.com](mailto:JDC_ShowSecretary@msn.com) prior to close of entries. Those received verbally by telephone are not acceptable.

**JUDGING SCHEDULE** will be posted on the Show Secretary website: [www.JDCurtis-ShowSecretary.com](http://www.JDCurtis-ShowSecretary.com) Mailed to each entrant (or e-mailed upon request) -- as soon as practical after closing of entries.

For information concerning entries, the Show Secretary can best be contacted by:

**E-mail: [JDC\\_ShowSecretary@msn.com](mailto:JDC_ShowSecretary@msn.com)**

**or by Phone / FAX: (970) 339 3272 after 9:00 a.m. & before 9:00 p.m.**

**AKC EVENT RECORDING & EVENT SERVICE FEES – effective 9/1/2011:**

	<b>Recording Fee 1<sup>st</sup> Entry</b>	<b>Service Fee 1<sup>st</sup> Entry</b>	<b>Service Fee Additional Entry</b>	<b>TOTAL 1<sup>st</sup> Entry / Additional</b>	
<b>Conformation</b>	<b>\$ .50</b>	<b>\$3.00</b>	<b>\$3.00</b>	<b>\$3.50</b>	<b>\$3.00</b>
<b>Obedience</b>	<b>\$ .50</b>	<b>\$3.00</b>	<b>\$3.00</b>	<b>\$3.50</b>	<b>\$3.00</b>
<b>Rally</b>	<b>\$3.50</b>	<b>- 0 -</b>	<b>\$3.00</b>	<b>\$3.50</b>	<b>\$3.00</b>

The A.K.C. will collect the above fees for each 1<sup>st</sup> Entry of a dog & each Additional Entry of the same dog in regular & non-regular recordable single entry classes in all A.K.C. Licensed & Member Club Events. Event-giving club shall assume the responsibility of collecting all fees for the A.K.C. & payment of all fees to the A.K.C. as stipulated in *AKC Rules Applying to Dog Shows, Chapter 11, Section 2*

The club may decline any entries for cause and may refuse to receive or may remove any dog on account of disease, viciousness or any other cause, and no person shall have any claim or recourse against the club or any official thereof.

There will be no drilling or intensive or corrective training of dogs on the show grounds or premises.

**NO DOUBLE HANDLING** will be permitted at this show. Individuals who attempt to double handle from outside the ring will be subject to action by the Show Committee.

There is no space provided for unentered dogs. Puppies and dogs not entered in this show are not permitted on the show grounds.

Dogs need be present only for scheduled judging and will be released if not needed for further judging. Dogs must be ready for judging. Neither the club nor its Show Secretary will be responsible or obligated to furnish any service for notifying exhibitors or their agents of breed or class judging. Judges need not wait for any dog holding up a class.

Owners or agents alone are responsible for the presence of their dogs in the judging rings.

The club reserves the right to substitute a prize of equal or greater value.

All trophies must be picked up at the show, none will be mailed.

All awards will be made in the judging ring to the person exhibiting the dog and that person shall be considered the rightful winner of the award.

**THE SHOW GIVING CLUB, THE SHOW SECRETARY, THEIR AGENTS, EMPLOYEES, ETC. ASSUME NO RESPONSIBILITY FOR ANY LOSS, DAMAGE, OR INJURY SUSTAINED BY EXHIBITORS, HANDLERS, OR TO ANY OF THEIR DOGS OR PROPERTY AND FURTHER ASSUME NO RESPONSIBILITY FOR INJURY TO CHILDREN WHILE AT OR ON THE SHOW GROUNDS, OR IN TRANSIT TO OR FROM THE SHOWS.**

**NOTICE – WAIVER OF RIGHTS: ALL PERSONS ATTENDING THIS DOG SHOW HEREBY WAIVE ANY CLAIM FOR DAMAGES AGAINST THE CLUB, ITS MEMBERS OR SHOW SECRETARY, IN THE EVENT A MOTOR VEHICLE OR CRATE HAS TO BE ENTERED TO RESCUE A DOG FROM OVERHEATING OR IMPROPERLY VENTED CONDITIONS**

**VETERINARY SERVICES**

**Northside Emergency Pet Clinic ON-CALL**

12299 Pennsylvania – Thornton CO 80241 (303) 252 7722

**Directions:** Exit Fairgrounds turning right (west) on Henderson Road to Riverdale Road – Turn right (north) to 128<sup>th</sup> Ave & go left (west) for approx. 5 miles to Washington Street – Turn left (south) to the clinic at 123<sup>rd</sup> & Washington

**Alameda East Veterinary Hospital / 24 Hour Clinic / ON-CALL**

9770 E Alameda Ave – Denver CO 80247 (303) 366 3527

**Directions:** East on Henderson to Hwy 85 – South to Hwy 270 -- East on 270 to Quebec exit – South on Quebec to Colfax Ave – East on Colfax to Havana – South on Havana to Alameda – Right to Veterinary Hospital

*Exhibitors will be responsible for all charges they incur in seeking veterinary treatments*

**EXHIBITORS SHOULD FOLLOW VETERINARIAN'S RECOMMENDATIONS TO ASSURE THEIR DOGS ARE FREE OF INTERNAL & EXTERNAL PARASITES, ANY COMMUNICABLE DISEASES & HAVE APPROPRIATE VACCINATIONS.**

**RIBBON PRIZES / SPECIALTY # 1 & SPECIALTY # 2 (unless otherwise indicated):**

**REGULAR CLASSES**

First Prize .....	Blue	<b>Ribbon</b>
Second Prize .....	Red	<b>Ribbon</b>
Third Prize.....	Yellow	<b>Ribbon</b>
Fourth Prize .....	White	<b>Ribbon</b>
Winners .....	Purple	<b>Rosette</b>
Reserve Winners .....	Purple & White	<b>Rosette</b>
Best of Winners .....	Blue & White	<b>Rosette</b>
Grand Champion Select .....	Light Blue & White	<b>Ribbon</b>
Best of Breed .....	Purple & Gold	<b>Rosette</b>
Best of Opposite Sex to Best of Breed .....	Red & White	<b>Rosette</b>

**NON-REGULAR CLASSES / SWEEPSTAKES / JUNIOR SHOWMANSIP:**

First Prize .....	Rose	<b>Ribbon</b>
Second Prize .....	Brown	<b>Ribbon</b>
Third Prize.....	Light Green	<b>Ribbon</b>
Fourth Prize .....	Grey	<b>Ribbon</b>
<b>Puppy Sweepstakes Offered at Specialty # 1 ONLY:</b>		
Best Junior Puppy & Best Senior Puppy .....	Pink & Green	<b>Rosette</b>
Best of Opposite Sex Junior Puppy & Senior Puppy.....	Lavender	<b>Rosette</b>
<b>Veteran Sweepstakes Offered at Specialty # 1 ONLY:</b>		
Best Veteran Dog & Best Veteran Bitch .....	Pink & Green	<b>Rosette</b>
Best Junior Handler Offered at Specialty # 1 ONLY .....	Rose & Green	<b>Rosette</b>

**SPECIAL AWARDS**

Award(s) of Merit .....	<b>Rosette</b>
-------------------------	----------------

**THE FOLLOWING REGULAR & NON-REGULAR CLASSES WILL BE OFFERED AT  
SPECIALTY # 1 and SPECIALTY # 2**

**CLASSIFICATION:** The following classes will be provided for both dogs and bitches

Puppy, 6 months – under 9 months	Bred By Exhibitor
Puppy, 9 months – under 12 months	American Bred
12 months to 18 months	Open
Novice	<b>WINNERS</b>

---

**NON-REGULAR CLASSES ..... SINGLE DOG ENTRIES**

**VETERAN DOGS ..... VETERAN BITCHES**

The following classes will be provided for both Veteran Dogs & Veteran Bitches:

**7 years & under 10 years                      and                      10 years & over**

**NOTE:** Chapter 11, Section 8, *AKC Rules Applying to Dog Shows* provides that castrated males **may be entered** in the Veteran Dog Class(s) and spayed females **may be entered** in the Veteran Bitch Class(s) at independent specialties only.

**NOTE:** 1<sup>st</sup> Place winners of Veteran Dog / Veteran Bitch Classes are eligible to compete for Best of Breed **IF** undefeated in any other class at this show.

**BEST OF BREED COMPETITION:**

See current edition of the *AKC Rules Applying to Dog Shows* or contact the Show Secretary for Best of Breed Entry Requirements; Move-Up Procedures, etc.

**A.K.C. GRAND CHAMPION TITLE POINTS:**

Effective May 12, 2010 – AKC Grand Champion Title Points may be awarded to Best of Breed / Variety; Best of Opposite Sex to Best of Breed / Variety & SELECT DOG & SELECT BITCH

See current edition of the *AKC Rules Applying to Dog Shows* or contact the Show Secretary for additional information on the Grand Champion Title Requirements

**AWARD(S) OF MERIT:** The judge may, at his / her discretion, award **UP TO TWO AWARD OF MERIT** Rosettes.

BOB; BOS; BW; WD; WB are not eligible for AOM Awards

**NON-REGULAR CLASSES ..... MULTIPLE DOG ENTRIES**

**STUD DOG CLASS** for stud dogs and at least two, but not more than three, of their get. Stud dogs must be entered in the Stud Dog Class and must be shown in the ring with their get. Owner of the stud dog need not necessarily be the owner of the get. Judging to be on the merits of the get. Get must be entered in another class in this show.

**BROOD BITCH CLASS**

same as for the stud dog except substitute brood bitch for stud dog and produce for get.

**NOTE:** Chapter 11, Section 8, *AKC Rules Applying to Dog Shows* provides that castrated males **may be entered** as Stud Dog and spayed females **may be entered** as Brood Bitch.

**BRACE CLASS ..... Fee is \$22.00 as a unit**

Effective 1/1/05 – **Two dogs of the same recognized breed or variety that are similar in appearance, performing in unison, and presented by a maximum of two handlers.**

**Both dogs in the Brace must have at least one common owner.**

- Dogs comprising a Brace must be named at the time of entry.
- Both dogs in the Brace **MUST BE ENTERED** in another class at this show with the appropriate individual Entry Fee plus "Brace As A Unit" Fee.
- Brace must be marked as an "Additional Class" on the Official AKC Entry Form. If more than one Brace is entered by an individual owner, please designate dogs comprising each Brace as "Brace # 1", "Brace # 2", etc.

**NOTE:** As the judges decision in the Stud Dog, Brood Bitch and Brace Classes is based upon the merits of more than one dog or bitch, no one of the dogs or bitches making up the entry judged first in these classes will be eligible to compete for Best of Breed by virtue of having won in these classes.

## TROPHY PACKAGE

Trophy Donors will be gratefully acknowledged in the Show Catalog

CNEA reserves the right to substitute a trophy of equal or greater value

### SPECIALTY # 1 / A.M.

BEST OF BREED .....	27 " Upright Suitcase
BEST OF OPPOSITE SEX .....	27 " Upright Suitcase
BEST OF WINNERS .....	Rosette
GRAND CHAMPION SELECT (Dog & Bitch) .....	Ribbon
AWARD(S) OF MERIT (up to 2) .....	Rosette
WINNERS DOG .....	20" Carry-On Suitcase
RESERVE WINNERS DOG .....	Rolling Duffel
WINNERS BITCH .....	20" Carry-On Suitcase
RESERVE WINNERS BITCH .....	Rolling Duffel
1 <sup>st</sup> PLACE IN EACH VETERAN CLASS .....	Luggage Item

### PUPPY SWEEPSTAKES:

BEST JUNIOR IN PUPPY SWEEPSTAKES .....	Luggage Accessory
BEST OF OPPOSITE SEX TO BEST JUNIOR IN PUPPY SWEEPS ...	Luggage Accessory
BEST SENIOR IN PUPPY SWEEPSTAKES .....	Luggage Accessory
BEST OF OPPOSITE SEX TO BEST SENIOR IN PUPPY SWEEPS ...	Luggage Accessory

### VETERAN SWEEPSTAKES:

BEST VETERAN DOG IN VETERAN SWEEPSTAKES .....	Luggage Accessory
BEST VETERAN BITCH IN VETERAN SWEEPSTAKES .....	Luggage Accessory

### JUNIOR SHOWMANSHIP:

BEST JUNIOR HANDLER .....	Rosette
---------------------------	---------



## PUPPY SWEEPSTAKES / VETERAN SWEEPSTAKES

OFFERED AT SPECIALTY # 1 ONLY

Judge: Mr. Howard E. (Butch) Engel

Entry Fee: \$22.00

---

**PUPPY SWEEPSTAKES** is open to all Norwegian Elkhounds who, on the day of the show, will be six (6) months old & under eighteen (18) months old.

1st Place Winners of the Junior Sweepstakes Classes will compete for **Best Junior in Puppy Sweepstakes** and **Best of Opposite Sex to Best Junior**.

1st Place Winners of the Senior Sweepstakes Classes will compete for **Best Senior in Puppy Sweepstakes** and **Best of Opposite Sex to Best Senior**.

There will be no competition between the Best Junior & Best Senior Winners.

Puppy Sweepstakes classes will be judged prior to the regular classes.

Dogs shown in Puppy Sweepstakes **MUST ALSO BE ENTERED** in one of the regular classes at the regular entry fee. Indicate "Sweepstakes and Age Division" on the Official AKC Entry Form under "Additional Classes".

Champions of Record **MAY NOT BE ENTERED** in Puppy Sweepstakes.

Puppy Sweepstakes is limited to amateur handlers and owners.

### PUPPY SWEEPSTAKES CLASSIFICATION

The following classes will be provided for both dogs and bitches

Junior, 6 months -- under 9 months

Senior, 12 months -- under 15 months

Junior, 9 months -- under 12 months

Senior, 15 months -- under 18 months

### DIVISION OF ENTRY MONEY AS PRIZES

35 % of the total Puppy Sweepstakes Entry Fees will be retained by the club for expenses. The remaining 65 % from each class will be awarded as follows:

1st Place / 50%

2nd Place / 25%

3rd Place / 15%

4th Place / 10%

---

**VETERAN SWEEPSTAKES** is open to all Norwegian Elkhounds who, on the day of the show, will be seven (7) years of age or older.

1st Place Winners of the Veteran Sweepstakes Classes will compete for **Best Veteran Dog in Veteran Sweepstakes** and **Best Veteran Bitch in Veteran Sweepstakes**.

There will be no competition between the Best Veteran Dog & Best Veteran Bitch Winners.

Veteran Sweepstakes classes will be judged prior to the regular classes.

Dogs shown in Veteran Sweepstakes **NEED NOT BE ENTERED** in one of the regular classes at this show. Indicate "Sweepstakes and Age Division" on the Official AKC Entry Form under "Dog Show Class" -- or if entered in another class, indicate Veteran Sweepstakes under "Additional Classes".

Castrated males and spayed females **may be entered** in Veteran Sweepstakes.

### VETERAN SWEEPSTAKES CLASSIFICATION

The following classes will be provided for both dogs and bitches

Veterans, 7 years & under 10 years

Veterans, 10 years & over

### DIVISION OF ENTRY MONEY AS PRIZES

35 % of the total Veteran Sweepstakes Entry Fees will be retained by the club for expenses. The remaining 65 % from each class will be awarded as follows:

1st Place / 50%

2nd Place / 25%

3rd Place / 15%

4th Place / 10%

**JUNIOR SHOWMANSHIP ..... OFFERED AT SPECIALTY # 1 ONLY**

**Judge:** Dr. Robert A. Indeglia

**Entry Fee:** **\$22.00** for Junior Showmanship ONLY  
**FREE** as an Additional Class / if dog is entered in another class at this show

**NOVICE JUNIOR CLASS** for boys and girls at least 9 & under 12 years of age on the day of the show; who at the time entries close **have not won 3 First Place awards**, with competition present, in a Novice Class at a licensed or member show.

**NOVICE INTERMEDIATE CLASS** for boys and girls at least 12 & under 15 years of age on the day of the show; who at the time entries close **have not won 3 First Place awards**, with competition present, in a Novice Class at a licensed or member show.

**NOVICE SENIOR CLASS** for boys and girls at least 15 & under 18 years of age on the day of the show; who at the time entries close **have not won 3 First Place awards**, with competition present, in a Novice Class at a licensed or member show.

**OPEN JUNIOR CLASS** for boys and girls at least 9 & under 12 years of age on the day of the show; who at the time entries close **have won 3 First Place awards**, with competition present, in a Novice Class at a licensed or member show.

**OPEN INTERMEDIATE CLASS** for boys and girls at least 12 & under 15 years of age on the day of the show; who at the time entries close **have won 3 First Place awards**, with competition present, in a Novice Class at a licensed or member show.

**OPEN SENIOR CLASS** for boys and girls at least 15 & under 18 years of age on the day of the show; who at the time entries close **have won 3 First Place awards**, with competition present, in a Novice Class at a licensed or member show.

**MASTER CLASS** for boys and girls who are at least 9 years old & under 18 years on the day of the show, and who **have won the 10 first place wins in an Open class with competition to be eligible to enter the Limited Class Competition**. The calendar for this class will be November 1 - October 31 of the following year. All Juniors meeting the criteria for this class are required to enter the Master Class and may change their entry the day of the show if entries have already closed. Once the eligibility time frame for that year has passed all participants return to the Open Class to compete for the following year.

The winner of a third first place in each Novice Class shall automatically become eligible to enter the corresponding Open Class at the show, provided the win is the third first place with competition and further provided there are one or more Junior Handlers competing in that Open Class.

**Eligibility of Dog:** Each dog entered in a regular Junior Showmanship Class must be of a breed eligible to compete in the conformation classes (including Miscellaneous Classes) at the event. Dogs may be PAL/ILP, Full-, or Limited-Registered to compete in Junior Showmanship Classes, additionally, spayed and neutered specimens are eligible for competition. Breeds excluded from competition at the event are not eligible. The dog must be entered in one of the classes associated with the event or must be entered for Junior Showmanship only. *An eligible dog other than the one entered may be substituted. A Junior is limited to one substitution at a dog show. Such substitution must be accompanied by an official AKC entry form. The junior must have the AKC number of the substitute dog. Substitutions must be made with the Superintendent or Show Secretary at least one half-hour prior to the scheduled start of any Junior Showmanship class at the show and may require payment of an additional entry fee. If one of the owners of the dog is a judge, the dog may be entered in Junior Showmanship Only to be exhibited by the Junior at an event where the judge is judging classes other than Junior Showmanship.* Each dog must be owned or co-owned by the Junior Handler or by the Junior Handler's father, mother, brother, sister, uncle, aunt, grandfather, or grandmother, including the corresponding step and half relations, or by a permanent member of the Junior Handler's household as recorded with The American Kennel Club at the time entries close or an application for transfer of ownership must be sent to The American Kennel Club by the new owner within seven days after the last day of the show. **BITCHES IN SEASON ARE NOT ELIGIBLE.**

At a Specialty Show, each dog must be of the breed for which the show is held.

Junior Handlers must include their **AKC JUNIOR HANDLER NUMBER** on each entry.

To obtain a Junior Handler number: Call ..... (919) 233-9767 Email ..... juniors@akc.org

**ALL INFORMATION FOR JUNIOR SHOWMANSHIP CLASSES MUST BE ENTERED ON BOTH THE FRONT & BACK OF THE OFFICIAL AKC ENTRY FORM.**

**HAVE A "MILE HI" WEEKEND WITH YOUR FRIENDS  
FOUR SHOWS – ONE LOCATION – BRIGHTON COLORADO**

<b>TWO NORWEGIAN ELKHOUND INDEPENDENT SPECIALTIES</b>	
<b>FRIDAY – APRIL 13, 2012</b>	<b>SPECIALTY # 1 / A.M. JUDGING</b>
<b>COLUMBINE NORWEGIAN ELKHOUND ASSOCIATION</b>	
<i>Specialty -- Regular &amp; Non-Regular Classes</i>	
<i>Puppy Sweepstakes / Veteran Sweepstakes / Junior Showmanship</i>	
<b>FRIDAY – APRIL 13, 2012</b>	<b>SPECIALTY # 2 / P.M. JUDGING</b>
<b>COLUMBINE NORWEGIAN ELKHOUND ASSOCIATION</b>	
<i>Specialty -- Regular &amp; Non-Regular Classes ONLY</i>	
Friday CNEA Specialties ..... Enter through Show Secretary, Jan D Curtis	

**FRIDAY, APRIL 13, 2012** **OBEDIENCE TRIAL -- INDOORS**

Open to All AKC-Recognized Breeds / All American Dogs / Mixed Breeds

**COLLIE CLUB OF COLORADO** ..... for Additional Information contact Trial Secretary

**Brenda Wood / 970 – 663 – 7197 / jumpindogs@yahoo.com**

Judge: Mrs. Susan Oviatt-Harris .....	Novice A	Beginner Novice A	Open A	Utility A
	Novice B	Beginner Novice B	Open B	Utility B

**FRIDAY, APRIL 13, 2012** **RALLY TRIAL -- INDOORS**

Open to All AKC-Recognized Breeds / All American Dogs / Mixed Breeds

**COLLIE CLUB OF COLORADO** ..... for Additional Information contact Trial Secretary

**Brenda Wood / 970 – 663 – 7197 / jumpindogs@yahoo.com**

Judge: Mr. Ronald V. Horn .....	Novice A	Advanced A	Excellent A
	Novice B	Advanced B	Excellent B

**SATURDAY – APRIL 14, 2012** **TERRY-ALL KENNEL CLUB**

Norwegian Elkhound Judge:	Mrs. Claire (Kitty) K. Steidel	***
---------------------------	--------------------------------	-----

Hound Group Judge:	Dr. Robert A. Indeglia	***
--------------------	------------------------	-----

**SUNDAY – APRIL 15, 2012** **TERRY-ALL KENNEL CLUB**

Norwegian Elkhound Judge:	Dr. Anthony D. DiNardo	***
---------------------------	------------------------	-----

Hound Group Judge:	Mrs. Claire (Kitty) K. Steidel	***
--------------------	--------------------------------	-----

**SATURDAY & SUNDAY TERRY-ALL KENNEL CLUB ALL-BREED SHOWS**

*also offer Jr. Showmanship, Obedience & Rally Trials*

\*\* AKC Approved

Superintendent for **ALL-BREED SHOWS:** **ONOFRIO -- P O Box 25764 – Oklahoma City OK 73125**  
**(405) 427 8181 / www.onofrio.com**

**CATALOG ADVERTISING**

**DEADLINE: MARCH 14, 2012**

- ✕ Catalog Advertising MUST BE SUBMITTED CAMERA READY (i.e. printed as submitted)
- ✕ No artwork will be done after receipt by CNEA
- ✕ A complimentary copy will be sent with each full-page catalog ad

1. **SUBMIT ONLY ORIGINAL PHOTOS** or
2. **SUBMIT ALL SCANS OR DIGITAL PHOTOS OR "CAMERA READY" ADS (Hi-Resolution 300 – 600 DPI) ON CD, NOT AS INKJET OR LASER PRINTOUTS**
3. **PLEASE MAKE ALL CAMERA READY & CD SUBMISSIONS:** **PC FORMAT ONLY**  
**NO MAC FORMAT DISKS OR PROGRAM FILES**  
 #1 CHOICE ..... **ADOBE PHOTOSHOP PSD, LAYERS PRESERVED**  
 #2 CHOICE ..... **HI-RES UNCOMPRESSED JPEG**  
 #3 CHOICE ..... **STANDARD PDF**  
 #4 CHOICE ..... **MS WORD OR PUBLISHER DOC**

Inside Cover (Front or Back) (One Photo) .....	\$50.00
Full Page (One Photo) .....	\$35.00
Half Page (One Photo) .....	\$20.00
Quarter Page (Business Card or Litter Announcement) .....	\$10.00
In Memorial .....	\$10.00

YOU MAY ALSO ORDER A MARKED CATALOG ..... \$ 7.50

**Please make checks payable to:** **CNEA**

**Mail, along with your ad copy to:** **JAN D CURTIS, SHOW SECRETARY**  
**2837 W 49<sup>TH</sup> STREET – EVANS CO 80620**

**Phone / Fax: 970 – 339 -- 3272** **e-mail: JDC\_ShowSecretary@msn.com**

**HOTELS & MOTELS**

Rooms at all hotels / motels are not guaranteed. Several events are scheduled in the area, so immediate reservations are encouraged.

Exhibitors are urged to avoid damage to hotel / motel property and to **CLEAN UP AFTER THEIR DOGS AT ALL TIMES**, thus assuring the continued use of these facilities.

Please do not leave dogs unattended or loose in rooms.

**CONTACT HOTELS DIRECTLY FOR CURRENT RATES & DOG RELATED POLICIES**

<b>RAMADA INN</b>	10 E. 120 <sup>th</sup> Ave -- Northglenn CO	(303) 452 4100
<b>SLEEP INN</b>	101 Grant Street – Denver CO	(303) 280 9818
<b>MOTEL 6</b>	65 S. Grand Ave – Ft Lupton CO	(303) 857 1800 1 800 466 8356
<b>SUPER 8 MOTEL</b>	12055 Melody Dr. – Westminster CO	(303) 451 7200 1 800 800 8000
<b>SUPER 8 BRIGHTON</b>	15040 Brighton Road – Brighton CO	(303) 659 6063
<b>LA QUINTA</b>	345 W. 120 <sup>th</sup> Ave – Westminster CO	(303) 252 9800

Provides CNEA Exhibitors, etc. with the following:

- Recent AKC Updates & Rule Changes Page
- Interactive PDF Forms for Entry Correction, Class Changes, Move-ups, etc.

**2012 Specialty Calendar Page – CNEA Section:**

- PDF Premium List
- Interactive On-Line Entry Form (PDF) with Link to PayPal Payment Account and Full Instructions for On-Line Entry **AND / OR** to Pre-Order Show Catalogs
- PDF Judging Schedule – will be posted as soon as possible after closing
- PDF Specialty Results – will be posted as soon as possible after the Specialty

---

---

**ROUTES TO SHOW SITE**

**FROM THE SOUTH:**

Exit at I-25 to I-76 East -- Left at I-76 / Hwy 85 fork -- North to 124<sup>th</sup> Ave -- Left on 124<sup>th</sup> to Show Site (on right)

**FROM THE NORTH:**

I-25 South to Hwy 7 -- Exit east on Hwy 7 to Hwy 85 -- South on Hwy 85 to 124<sup>th</sup> Ave  
Right on 124<sup>th</sup> to Show Site (on right)      **OR**

North or South on Hwy 85 to 124<sup>th</sup> Ave -- Left or Right on 124<sup>th</sup> to Show Site (on right)

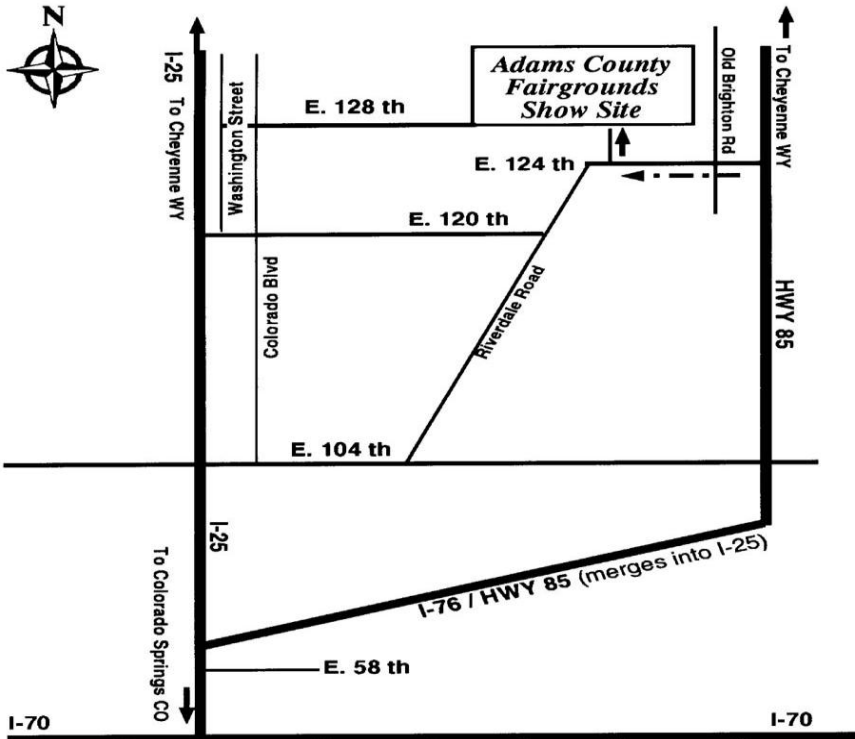

## TERRY-ALL KENNEL CLUB – ATTENTION EXHIBITORS

### PLEASE CLEANUP AFTER YOUR DOGS ON THE SHOW SITE GROUNDS

There will be **NO ACCESS** to Adams County Fairgrounds Buildings **prior to 7:00 a.m., April 13, 2012**

The Show Site will be available to all exhibitors at 7:00 a.m., Saturday, April 14, 2012 & Sunday April 15, 2012. Dogs must be removed from the show site immediately following Best In Show Judging, Sunday, April 15, 2012.

The parking lots will be available on Saturday, April 14, 2012. **PLEASE OBSERVE THE NO PARKING & RESERVED PARKING AREAS.** Vehicles parked in Fire Lanes and No Parking Zones and unauthorized vehicles parked in the Reserved Parking Areas are subject to towing at the owners' expense. **Police Officers will be on duty all weekend to enforce Fire Lane and Parking Rules, violators may be ticketed or towed.** Parking will be under the rules of the Adams County Regional Park. There is a fee for Overnight Parking (See Premium List Insert). The Fairgrounds are locked at 11:00 p.m.. No cars will be allowed in or out from 11:00 p.m. to 7:00 a.m.

**NO PARKING NEAR THE 4-H GOOD LUCK BUILDING. VIOLATORS WILL BE TOWED.**

**NO SMOKING** in any of the buildings.

There will be no filming of these shows except for one's personal use. Any other use must be cleared with the Show Chairman.

**The Show Committee reserves the right to establish such other rules as it may deem necessary (which are not in conflict with AKC rules) on the day of the show.**

**Violations of show rules, failure to follow instructions of the Show Committee or incidents of misconduct will result in the calling of an Event Committee Hearing and possible loss of AKC privileges.**

If any type of dog related clean-up is required in the show ring(s), the Steward will hold the dog while the exhibitor does the clean-up.

### HORSE STALLS – COMPLIMENTARY (FREE) GROOMING & CRATING SPACES

Stalls available for set-up on Friday, April 13, 2012

**NO ELECTRICAL OUTLET USE** – Bring trash bags & clean up your area before you leave

**BULL SALE BARN** will be available if it snows

### ELECTRICAL POWER – IS LIMITED AT ADAMS COUNTY FAIRGROUNDS

Electricity is for RV's with Pre-Paid Hook-Up Reservations

**NO ONE IS ALLOWED TO PLUG INTO ANY OTHER ELECTRICAL OUTLET**

Unauthorized use of electricity is in violation of Terry-All Kennel Club Rules and can result in loss of privileges or further disciplinary action

**OBEDIENCE / RALLY EXHIBITORS – SHOULD REFER TO THE TERRY-ALL KENNEL CLUB PREMIUM LIST FOR RULES APPLYING TO THEIR USE OF THE DOME BUILDING AT THE FAIRGROUNDS.**

**ALL SPECIALTY AND ALL-BREED SHOW EXHIBITORS – SHOULD REFER TO THE TERRY-ALL KENNEL CLUB PREMIUM LIST FOR ADDITIONAL RULES AND REGULATIONS REGARDING FAIRGROUNDS ACCESS, RESERVED AND GENERAL PARKING AND GENERAL USE OF THE FAIRGROUNDS BUILDINGS.**

**TERRY-ALL KENNEL CLUB ALL-BREED PREMIUM LIST is available through**

Superintendent: Onofrio Dog Shows

Oklahoma Office (405) 427 8181 or  
Oregon Office (503) 239 1080

You can also download the Terry-All K.C. Premium List from the Onofrio website [www.onofrio.com](http://www.onofrio.com) / select Show Information / Up-Coming Shows / Scroll down to Terry-All Kennel Club

**OFFICIAL AMERICAN KENNEL CLUB ENTRY FORM**



SEE PAGE 3 FOR ENTRY FEES: Includes ALL required AKC Recording & Event Service Fees

ENTRIES CLOSE: 5:00 PM -- WEDNESDAY -- MARCH 28, 2012  
or when numerical limit has been reached, if reached prior to this date & time

MAKE ALL CHECKS PAYABLE TO: Columbine Norwegian Elkhound Association

MAIL TO: Jan D Curtis, Show Secretary -- 2837 W. 49th St. -- Evans CO 80620-9516

PLEASE CHECK MARK EACH SHOW & THE APPROPRIATE EVENTS YOU ARE SUBMITTING  
ENTRIES FOR -- SEPARATE ENTRY FEE IS REQUIRED FOR EACH DOG, EACH SHOW

**4 / 13 / 12 Event # 2012-053901 -- SPECIALTY # 1 / A.M. JUDGING -- Entry Limit 100 dogs**

\_\_\_\_ Specialty #1 -- Regular & Non-Regular Classes  
\_\_\_\_ Puppy Sweeps / \_\_\_\_ Veteran Sweeps / \_\_\_\_ Jr. Showmanship TOTAL \$ \_\_\_\_\_

**4 / 13 / 12 Event # 2012-053903 -- SPECIALTY # 2 / P.M. JUDGING -- Entry Limit 100 dogs**

\_\_\_\_ Specialty #2 -- Regular & Non-Regular Classes ONLY TOTAL \$ \_\_\_\_\_

Pre-Order Show Catalog(s) -- see Page 2 ..... # \_\_\_\_\_ @ \$7.00 each TOTAL \$ \_\_\_\_\_

**TOTAL FEES ENCLOSED \$ \_\_\_\_\_**

BREED <b>NORWEGIAN ELKHOUND</b>	VARIETY (1)	SEX _____ MALE _____ FEMALE
--	-------------	--------------------------------

DOG SHOW CLASS (2-3)	CLASS DIVISION, weight, color, etc (3)
----------------------	--

ADDITIONAL CLASSES:

<del>OBEEDIENCE TRIAL ENTRY:</del>	<del>RALLY TRIAL ENTRY:</del>	JUNIOR SHOWMANSHIP: _____	MASTER CLASS _____
<del>CLASS</del>	<del>CLASS</del>	NOVICE: JUNIOR _____	OPEN: JUNIOR _____
<del>ADD'L CLASS</del>	<del>ADD'L CLASS</del>	INTER _____	INTER _____
<del>JUMP HEIGHT</del>	<del>JUMP HEIGHT</del>	SENIOR _____	SENIOR _____

NAME OF JUNIOR HANDLER <small>MUST complete ALL Jr. Show. information on the back of the Entry Form</small>	JUNIOR HANDLER NUMBER
---	-----------------------

FULL NAME OF DOG

AKC REG. NUMBER:	DATE OF BIRTH
PAL NUMBER:	PLACE OF BIRTH _____ USA _____ CANADA
COUNTRY OF FOREIGN REG:	LIST COUNTRY _____ / FOREIGN
FOREIGN REG. NUMBER:	

BREEDER: \_\_\_\_\_

SIRE: \_\_\_\_\_

DAM: \_\_\_\_\_

ACTUAL OWNERS (4): \_\_\_\_\_

OWNERS ADDRESS: \_\_\_\_\_

CITY: \_\_\_\_\_ STATE: \_\_\_\_\_ ZIP: \_\_\_\_\_

NAME OF OWNERS AGENT (IF ANY) AT THIS SHOW \_\_\_\_\_

I CERTIFY that I am the actual owner of the dog or that I am the duly authorized agent of the actual owner whose name I have entered above. In consideration of the acceptance of this entry. I (we) agree to abide by the rules and regulations of the American Kennel Club in effect at the time of this event, and by any additional rules and regulations appearing in the premium list for this event, and further agree to be bound by the "Agreement" printed on the reverse side of this entry form. I (we) certify and represent that the dog entered is not a hazard to persons or other dogs. The entry is submitted for acceptance on the foregoing representation and Agreement. I (we) agree to conduct myself (ourselves) in accordance with all such Rules and Regulations (including all provisions applying to discipline) and to abide by any decisions made in accord with them.

SIGNATURE of owner or agent  
duly authorized to make this entry \_\_\_\_\_

TELEPHONE # (s) \_\_\_\_\_

E-MAIL ADDRESS \_\_\_\_\_

#### AGREEMENT

I (we) agree that the club holding this event has the right to refuse this entry for cause which the club shall deem sufficient. In consideration of the acceptance of this entry and of the holding of this event and of the opportunity to have the dog judged and to win prizes, ribbons, or trophies, I (we) agree to hold the AKC, the event-giving club, their members, directors, governors, officers, agents, superintendents or event secretary and the owner and/or leaseholder of the premises and any provider of services that are necessary to hold this event and any employees or volunteers of the aforementioned parties, and any AKC approved judge, judging at this event, harmless from any claim for loss or injury which may be alleged to have been caused directly or indirectly to any person or thing by the act of this dog while in or about event premises or grounds or near any entrance thereto, and I (we) personally assume all responsibility and liability for any such claim; and I (we) further agree to hold the aforementioned parties harmless from any claim for loss, injury or damage to this dog.

Additionally, I (we) hereby assume the sole responsibility for and agree to indemnify, defend and save the aforementioned parties harmless from any and all loss and expense (including legal fees) by reason of the liability imposed by law upon any of the aforementioned parties for damage because of bodily injuries, including death at any time resulting therefrom, sustained by any person or persons, including myself (ourselves), or on account of damage to property, arising out of or in consequence of my (our) participation in this event, however such, injuries, death or property damage may be caused, and whether or not the same may have been caused or may be alleged to have been caused by the negligence of the aforementioned parties or any of their employees, agents, or other persons. **I (WE) AGREE THAT ANY CAUSE OF ACTION, CONTROVERSY OR CLAIM ARISING OUT OF OR RELATED TO THE ENTRY, EXHIBITION OR ATTENDANCE AT THE EVENT BETWEEN THE AKC AND THE EVENT-GIVING CLUB (UNLESS OTHERWISE STATED IN ITS PREMIUM LIST) AND MYSELF (OURSELVES) OR AS TO THE CONSTRUCTION, INTERPRETATION AND EFFECT OF THIS AGREEMENT SHALL BE SETTLED BY ARBITRATION PURSUANT TO THE APPLICABLE RULES OF THE AMERICAN ARBITRATION ASSOCIATION. HOWEVER, PRIOR TO ARBITRATION ALL APPLICABLE AKC BYLAWS, RULES, REGULATIONS AND PROCEDURES MUST FIRST BE FOLLOWED AS SET FORTH IN THE AKC CHARTER AND BYLAWS, RULES, REGULATIONS, PUBLISHED POLICIES AND GUIDELINES.**

#### INSTRUCTIONS

- VARIETY** – If you are entering a dog of a breed in which there are varieties for show purposes, please designate the particular variety you are entering, i.e., Cocker Spaniel (Solid Color Black, ASCOB, Parti-Color), Beagles (not exceeding 13 in., over 13 in. but not exceeding 15 in.), Dachshunds (Longhaired, Smooth, Wirehaired), Collies (Rough, Smooth), Bull Terriers (Colored, White), Manchester Terriers (Standard, Toy), Chihuahuas (Smooth Coat, Long Coat), English Toy Spaniels (King Charles and Ruby, Blenheim and Prince Charles), Poodles (Toy, Miniature, Standard).
- DOG SHOW CLASS** -- The following categories of dogs may be entered and shown in **BEST OF BREED COMPETITION**: Dogs that are Champions of Record and dogs which, according to their owners' records, have completed the requirements for a championship, but whose championships are unconfirmed. The showing of unconfirmed Champions in Best of Breed competition is limited to a period of 90 days from the date of the show where the dog completed the requirements for a championship.
- DOG SHOW CLASS / CLASS DIVISION** – Consult the classification in this premium list. If the event class in which you are entering your dog is divided, then, in addition to **DESIGNATING THE CLASS**, specify the particular **DIVISION OF THE CLASS** in which you are entering your dog, i.e., age division, color division, weight division.
- ACTUAL OWNERS** -- A dog must be entered in the name of the person who actually owned it at the time entries for an event closed. If a registered dog has been acquired by a new owner it must be entered in the name of its new owner in any event for which entries closed after the date of acquirement, regardless of whether the new owner has received the registration certificate indicating that the dog is recorded in his name. State on entry form whether transfer application has been mailed to the AKC. (For Complete rules, refer to Chapter 11, Section3).
- Dogs entering **MIXED BREED CLASSES** (eligible only in standalone Agility, Obedience and Rally Trials) should mark Breed as "MIXED BREED". Variety, Breeder, Sire, Dam information shall remain blank for mixed breed entrants.

---

IF THIS ENTRY IS FOR **JUNIOR SHOWMANSHIP** YOU MUST PROVIDE THE FOLLOWING INFORMATION:

JUNIOR'S DATE OF BIRTH \_\_\_\_\_

AKC JUNIOR HANDLER NUMBER \_\_\_\_\_

**The above Junior Handler Number MUST be included.** Should you not have your Junior Handler Number, this may be obtained from the American Kennel Club. Phone 919 – 816 – 3776

**By signing the entry form I (we) certify that the Junior Showman does not now, and will not at any time, act as an agent / handler for pay while continuing to compete in Junior Showmanship.**

ADDRESS \_\_\_\_\_

CITY \_\_\_\_\_ STATE \_\_\_\_\_ ZIP \_\_\_\_\_

If Junior Handler is NOT THE OWNER of the dog identified on the face of this form,  
what is the relationship of the Junior Handler to the Owner? \_\_\_\_\_

## RESERVED GROOMING FOR TERRY-ALL KENNEL CLUB

- Reserved Grooming will be in the Indoor (Dirt) Arena.
- Building will be OPEN BY 7:00 A.M. both Saturday and Sunday.
- NO SET-UP ON FRIDAY will be allowed except for Specialty Club Exhibitors who will have tags on their equipment. Items without tags will be removed and subject to a \$25 Storage Fee.
- **RESERVATION FEES: \$25.00 for two (2) days. No one (1) day reservations will be accepted.**
- The Grooming Area will be monitored throughout the day. Please keep your space clean. Failure to follow the instructions of a Show Committee member can result in forfeiture of reserved space(s).
- The building will be locked by 7:00 p.m.
- Spaces are approximately eight (8) feet wide and eight (8) feet long.
- Electric will be available and must be shared. No space has exclusive use of any outlet.
- No dogs can be left in the Grooming Area overnight.
- Do not bathe your dogs in the bathrooms.
- No exercise pens will be allowed.
- No email, walk-ins, or telephone Grooming Reservations will be accepted.
- Reservations are limited to three (3) spaces per reservation form with two (2) forms per envelope for a total of 6 spaces per envelope. There are a limited number of reservations.
- Reservations will be confirmed if a self-addressed, stamped envelope is provided.
- Reservations will be returned unopened if the limit is reached.
- TAKC (Terry-All Kennel Club) is NOT responsible for lost or stolen items.

---

### TERRY-ALL KENNEL CLUB RESERVED GROOMING REQUEST

Name \_\_\_\_\_

Address \_\_\_\_\_

City, State, Zip Code \_\_\_\_\_

Every effort will be made to assign spaces together when they are received together, however this cannot be guaranteed.

Total amount enclosed \$ \_\_\_\_\_

I, the undersigned understand that this reservation(s) will be accepted on a first-come-first-serve basis and that I will accept the space(s) that I am assigned. I further understand that the Reserved Grooming space is a privilege that can be withdrawn from those who do not follow the Rules and Regulations of Terry-All Kennel Club (TAKC) or their agents.

Signature \_\_\_\_\_

Signature of responsible person

Cell Phone \_\_\_\_\_

**RESERVATIONS CLOSE: MARCH 28, 2012 OR WHEN LIMIT ON SPACE IS REACHED**

**MAKE CHECKS PAYABLE TO and MAIL TO:**

**TERRY-ALL KENNEL CLUB  
1278 LARK AVENUE  
BRIGHTON CO 80601**

# RESERVED DAY PARKING

Day Parking – Please complete the form

NAME \_\_\_\_\_

ADDRESS \_\_\_\_\_

CITY \_\_\_\_\_ STATE \_\_\_\_\_ ZIP \_\_\_\_\_

PHONE \_\_\_\_\_ E-MAIL \_\_\_\_\_

Vehicle Make & Size \_\_\_\_\_

Vehicle License # & State \_\_\_\_\_

**A limited number of sites are available**

**Reservations close March 28, 2012, or when space has been filled**

**SATURDAY -- APRIL 14, 2012**

\_\_\_\_\_ Car / \$5.00                      \_\_\_\_\_ Additional Space for X-Pens (Auto Space) / \$2.50

\_\_\_\_\_ Camper / \$10.00                      \_\_\_\_\_ Additional Space for X-Pens (Camper Space) / \$5.00

**SUNDAY -- APRIL 15, 2012**

\_\_\_\_\_ Car / \$5.00                      \_\_\_\_\_ Additional Space for X-Pens (Auto Space) / \$2.50

\_\_\_\_\_ Camper / \$10.00                      \_\_\_\_\_ Additional Space for X-Pens (Camper Space) / \$5.00

**RESERVED PARKING WILL BE ON THE SOUTH SIDE OF THE DOME BUILDING ONLY**

**THERE IS NO FREE OVERNIGHT PARKING**

**PLEASE INCLUDE A SELF-ADDRESSED ENVELOPE & WE WILL MAIL YOUR SPACE NUMBER TO YOU**

**MAKE CHECKS PAYABLE TO:**

**GDCGD**

**SEND DAY PARKING RESERVATIONS TO:**

**KELLY MARTIN  
17544 CLARA LEE STREET  
BRIGHTON CO 80603**

**NO PHONE CALLS PLEASE**

Any person intentionally disregarding the instructions of the Parking Chairman or using abusive language will be brought before the Event Committee.

**I, the undersigned, understand that this reservation will be accepted on a first come - first served basis and that I will accept the reserved parking area I am assigned. I further understand that any violations of the parking rules will result in a loss of my reserved parking area. If it is necessary for the club to have my vehicle towed away, I am aware that towing charges will be at my expense. I have read the parking rules and agree to abide by them.**

SIGNATURE \_\_\_\_\_

No Reservations will be accepted without a signature

**NO VEHICLE WILL BE ADMITTED UNTIL ..... 7:00 A.M.  
FAIRGROUNDS WILL BE LOCKED AT ..... 11:00 P.M.**

# RV PARKING REQUEST

NAME \_\_\_\_\_

ADDRESS \_\_\_\_\_

CITY \_\_\_\_\_ STATE \_\_\_\_\_ ZIP \_\_\_\_\_

PHONE \_\_\_\_\_ E-MAIL \_\_\_\_\_

License Plate # & State \_\_\_\_\_

\_\_\_\_ Motor Home      \_\_\_\_ Towed Trailer      \_\_\_\_ Pickup / with Camper

\_\_\_\_ Length              \_\_\_\_ 30 AMP              \_\_\_\_ 50 AMP

Total Width (including sliders) \_\_\_\_\_

Side location of sliders    \_\_\_\_ Right    \_\_\_\_ Left    \_\_\_\_ Both

Approximate Arrival Time \_\_\_\_\_

\_\_\_\_ Thursday, April 12    \_\_\_\_ Friday, April 13    \_\_\_\_ Saturday, April 14

**FEES:**    \_\_\_\_ No Services ..... \$10.00 per night

\_\_\_\_ Electricity (10 spots only) ..... \$20.00 per night

\_\_\_\_ Water & Electricity (13 spots only) ..... \$25.00 per night

**TOTAL FEES ENCLOSED**    \$ \_\_\_\_\_

---

Adams County Regional Park grounds will be open at **NOON, THURSDAY, APRIL 12, 2012**

A limited number of sites are available, mail reservations early !

Reservations close **MARCH 28, 2012**, or when space has been filled

You will be parked at the discretion of the Parking Personnel

If you want to park next to a friend, submit Reservations & Fees together in the same envelope

**PLEASE INCLUDE A SELF-ADDRESSED LARGE ENVELOPE & WE WILL MAIL YOUR PARKING CONFIRMATION & MAP TO YOU**

---

**MAKE CHECKS PAYABLE TO:**

**TERRY-ALL KENNEL CLUB**

**MAIL RV RESERVATIONS TO:**

**BILL & PAM LEE**

**P O BOX 31021 – AURORA CO 80041**

**NO PHONE CALLS OR E-MAILS**

Any person intentionally disregarding the instructions of the Parking Personnel or using abusive language with the Parking Personnel will be brought before the Event Committee.

I, the undersigned, understand that this reservation will be accepted on a first come - first served basis and that I will accept the overnight parking area I am assigned. I further understand that any violations of the parking rules will result in a loss of my overnight parking privileges. If it is necessary for the club to have my vehicle towed away, I am aware that towing charges will be at my expense. I have read the parking rules and agree to abide by them.

SIGNATURE \_\_\_\_\_

No Reservations will be accepted without a signature

**NO VEHICLE WILL BE ADMITTED UNTIL ..... 7:00 A.M.**

**FAIRGROUNDS WILL BE LOCKED AT ..... 11:00 P.M.**

**DUMP STATION IS AVAILABLE ON THE SHOW SITE**